

# Hot/Cold Combo Case

Engineered for store ambient conditions not to exceed  
75 degrees and 50% relative humidity.



# amtekco



A Wasserstrom Company

Manufacturers of Quality Products for the Food Marketing Industry

1205 Refugee Road • Columbus, Ohio 43207  
800-336-4677 or 614-228-6590 • Fax: 614-737-8017  
[www.amtekco.com](http://www.amtekco.com)

# Hot/Cold Combo Case

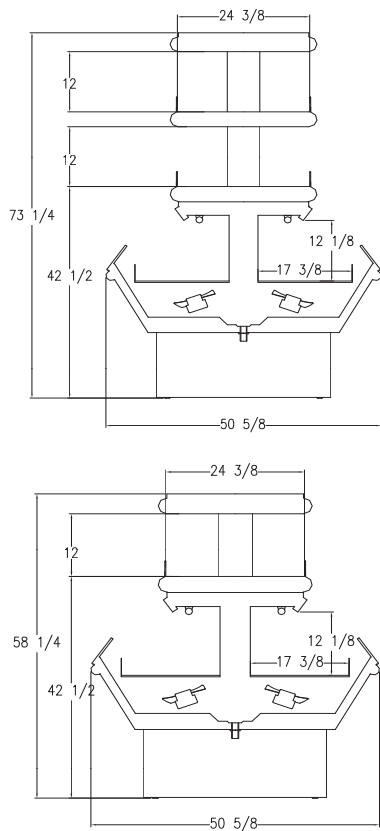

HOT DISPLAY ELECTRICAL				
MODEL NUMBER	TEIR	AMPS	VOLTAGE	PLUG
AHCDI-1	1	12.8	120	NEMA 5-20P
AHCDI-2	2	15.6	120/280V	NEMA L14-20P

REFRIGERATION DISPLAY (SAME FOR BOTH MODELS)				
REFRIGERATION CAPACITY (BTUH)	ELECTRICAL			
	REMOTE		SELF-CONTAINED	
	VOLTAGE	AMPS	AMPS	PLUG
6500	120V	2	15.6	NEMA L5-30P

## Standard features:

- 2-sided display
- 5' x 5' foot print
- Shopping cart protection @ 3 sides
- Flow-over air curtain refrigeration
- Clear tempered glass sides
- Durable powder coated finish interior & exterior
- Electronic programmable ECM fan motors
- Engineered to hold products at 35 – 41 degrees
- Conforms to UL 471, NSF-7 and CAN/CSA C22.2

## Self-contained option:

- Copeland condensing unit
- Condensation evaporator pan
- Cool air intake through front

## Self-contained option (continued):

- Warm air discharge at back to prevent re-circulation issues
- Sporlan internal equalized expansion valve
- Dixell electronic controller features automatic defrost
- Hard wired to field electric

## Remote option:

- Sporlan internal equalized expansion valve per refr. type
- Optional set up for third-party control probes
- Optional Glycol refrigeration set up
- NSF approved leveler feet in lieu of casters

## Other options available:

- Stainless steel construction, interior & exterior
- Flip down grill with interchangeable filter
- Ambient end cap display shelves for cross merchandising
- Display risers to minimize capacity while providing full display
- Custom powder coated finish, color specified by customer
- Private label branding with vinyl applied graphics
- Liquid line ball valve
- Heavy-duty swivel casters for mobility
- NEMA cord & plug

**Contact your Amtekco sales representative: 1-800-336-4677**

**amtekco**

A Wasserstrom Company

Manufacturers of Quality Products for the Food Marketing Industry

**Equipment That Means Business**